



**Torolalana momban`ny fomba fanamboarana ny
FIKAPOHAM-BARY AHODINA MILINA**



**MINISTERAN`NY FAMBOLENA REPOBLIKAN`NY MADAGASIKARA
DIRECTION REGIONALE DU DEVELOPPEMENT RURAL (DRDR)
JAPAN INTERNATIONAL COOPERATION AGENCY (JICA)
CENTRE DE FORMATION ET D`APPLICATION DU MACHINISME AGRICOLE
MINISTRY OF AGRICULTURAL REPUBLIC OF INDONESIA**



2010

Fikapoham-bary ahodina milina

A. Ny akora ilaina

1. Hazo
2. Fer corniere 30 x 30 x 3
3. Fer plat 30 x 3
4. Jante-na bisikleta par 16
5. Fer rond Ø25; Ø10; Ø4
6. Tole plane noire
7. Blao
8. Electrode
9. Visy Ø4

B. Ny fitaovana ilaina

1. Poste soudure
electrique
2. Marteau
3. Pince universelle
4. Tsofam-by
5. Ebarbeuse
6. Tour parallele
7. Perceuse
8. Tronçonneuse
9. Hetim-by
10. Fandraka
11. Clés
12. Ripsaw
13. Tsofan-kazo
14. tournevis
15. Vakona

Ny fikapoham-bary ahodina milina (Power tiller thresher)

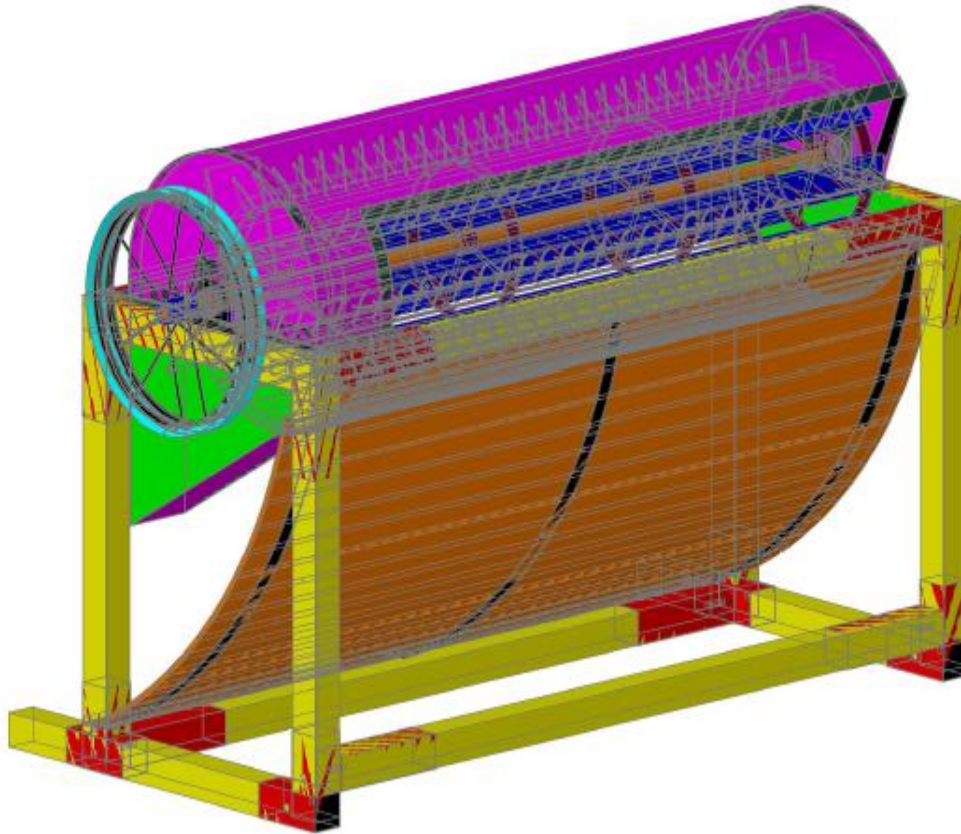

	Anarana	Akora
1.	Tanjany (Bati)	Hazo
2.	Sarony	Vy
3.	Tambour	Vy sy hazo
4.	Système de transmission	Vy
5.	Fivoahan`ny voam-bary	Hazo
6.	Fivoahan`ny mololo	Vy fotsy

Ny fanamboarana



Ny “Bati”:

Maka maridrefy 60 x 60 mm ho an`ny sakany ary ny lavany 1610 mm Izay manana zoro 4 maridrefy na 800 mm 6 maridrefy. Rehefa maka ny <<roulette>> eo aminy masinina kia maka efatra marijiro eo amin`ny akavanana aorianan`izay dia tohizana ny fanamboarana

NY refin`ny "Bati"



Refiny :

1. Ahavony = 830 mm
2. halavany = 1610 mm
3. Sakany = 620 mm
4. Lanjany = ± 100 kg

Gousset d`assemblage

1. Manapaka vy fisaka mirefy 3x 30mm, izay notapahina taminy fanapahana vy. Ny lavany 150mm mihisa 20 ary 180 mm mihisa 20
2. Mandavaka lavaka boribory mielanelana 50mm aminy fandavahina mirefy $\varnothing 4$ mm.
3. Aforitra ny vy fisaka mirefy 150mm dia atambatra aminy soudure ny sisiny roa ho toy ny fer corniere, ka mihisa 20 izy ireo. Ary atambatra aminy vis ny fametahana azy aminy hazo.
4. Ny Mirefy 180mm kosa dia tapahina ary atambatra araky ny sary.

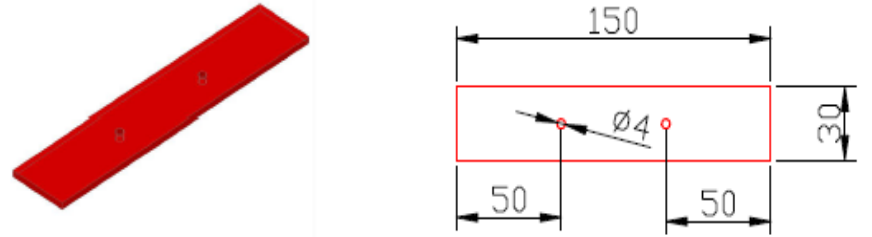

Plat 30 x3

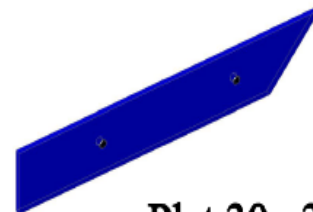
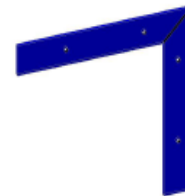
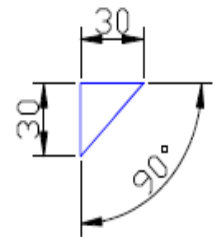
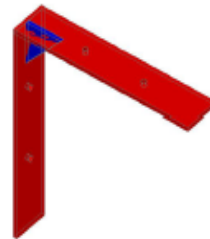

Plat 30 x3

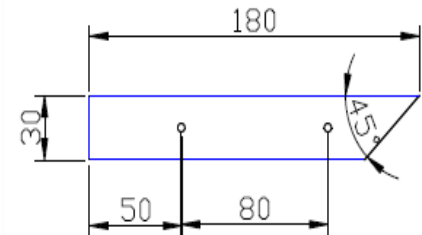

Toy izao ny sarin`ny fanambarana ny hazo amin`ny alalan`ny “Gousset d`assemblage”

Izao hitatsika izao ny sary rehefa voampetaka ny “Gousset d`assemblage” izay miaraka tamin`ny hazo ary narafitra tamin`ny vis ny fametahana azy

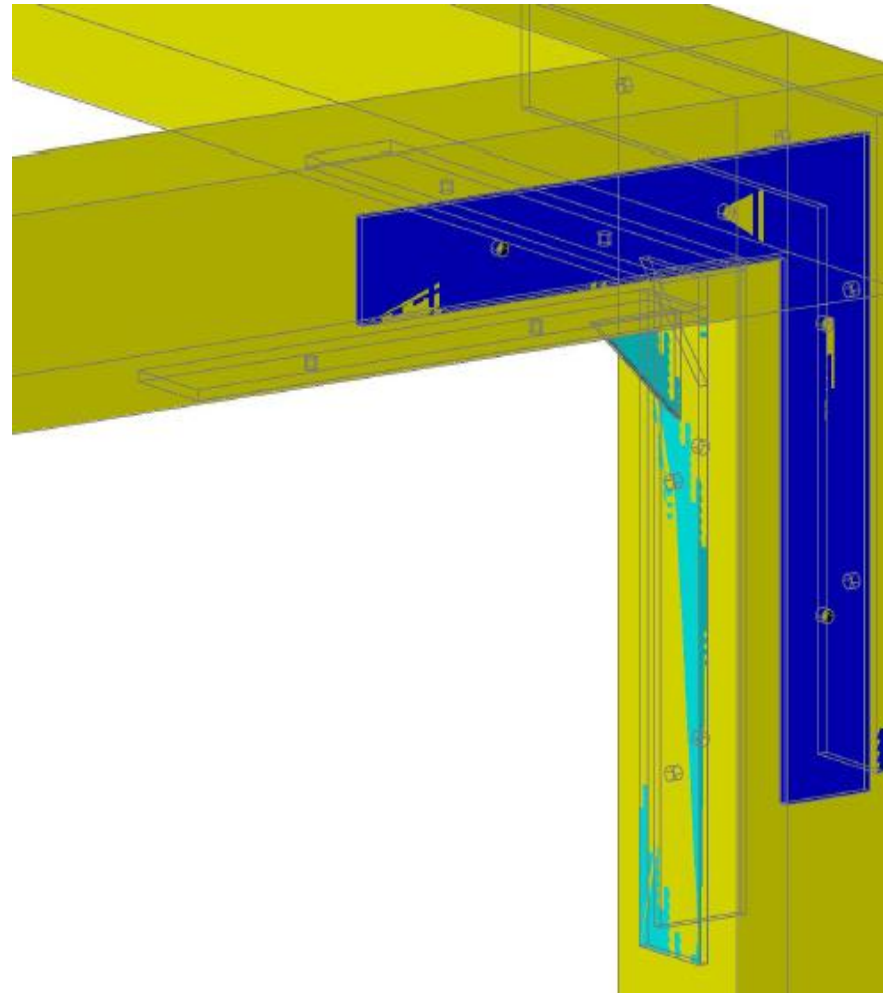

Tambour

	Anarana	Akora
1.	Aksa	Vy
2.	Hazo mitondra ny nifiny	hazo
3.	Nifiny	Vy
4.	Cerceau	vy
5.	Bague	Vy
6.	Cage a roulement	Vy
7.	Pale	Vy

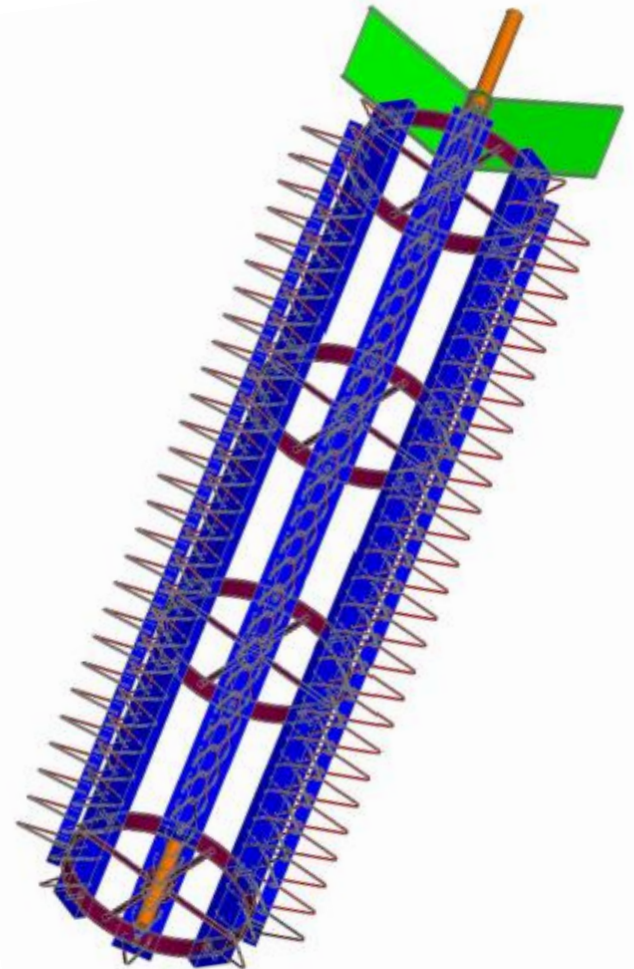

Aksa

Ny aksa dia vita amin`ny vy boribory manana savaivo \emptyset 25 mm ary manana halava 1705, araky ny asehon`ny sary.

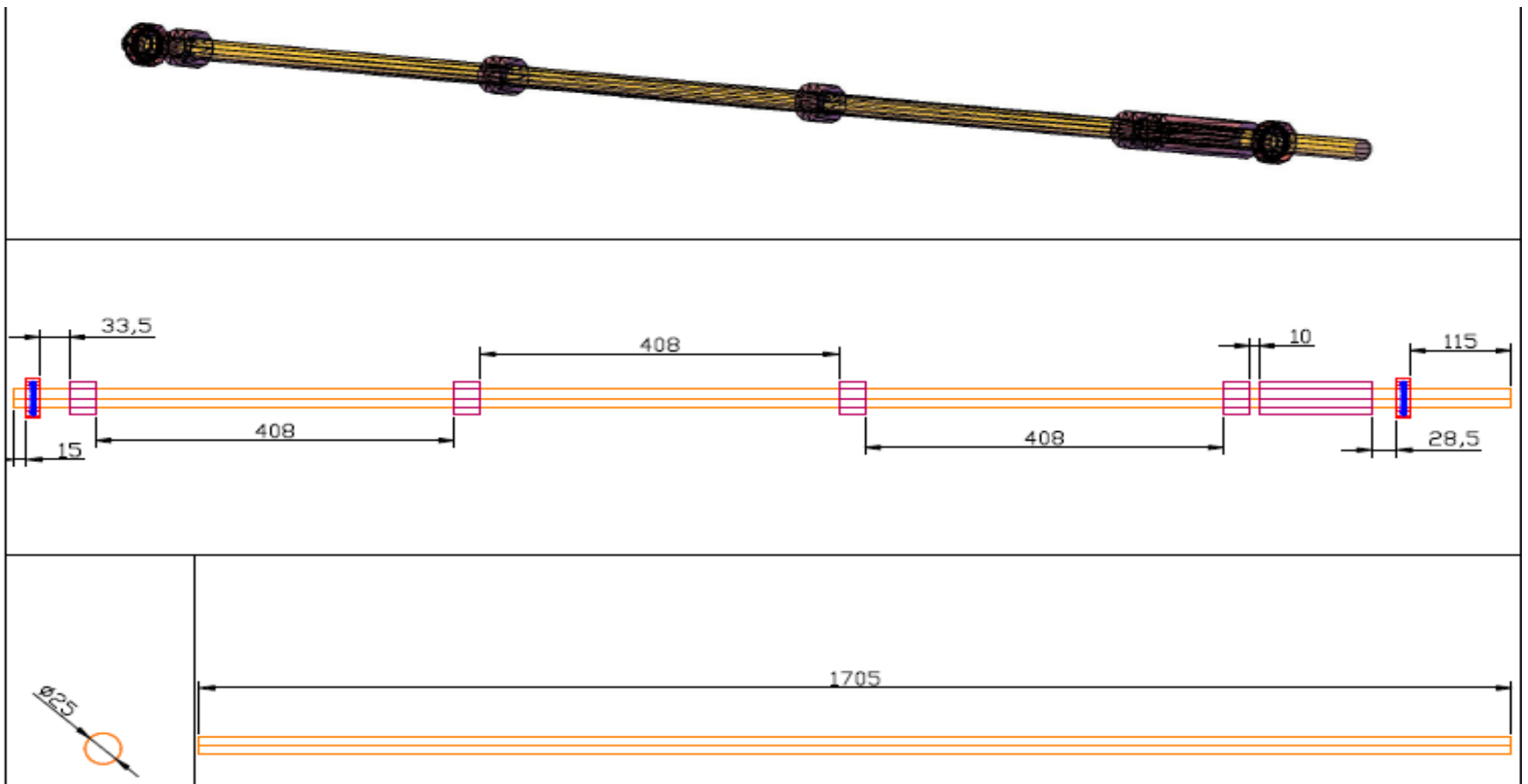

Hazo impetrahan`ny tanamasoandro

Eo amin`ny fametahana ny « Nifinifiny » dia misy refy tsy maintsy arahana.

Halavan`ny hazo =1344mm

Ny sakan`ny hazo=60mm

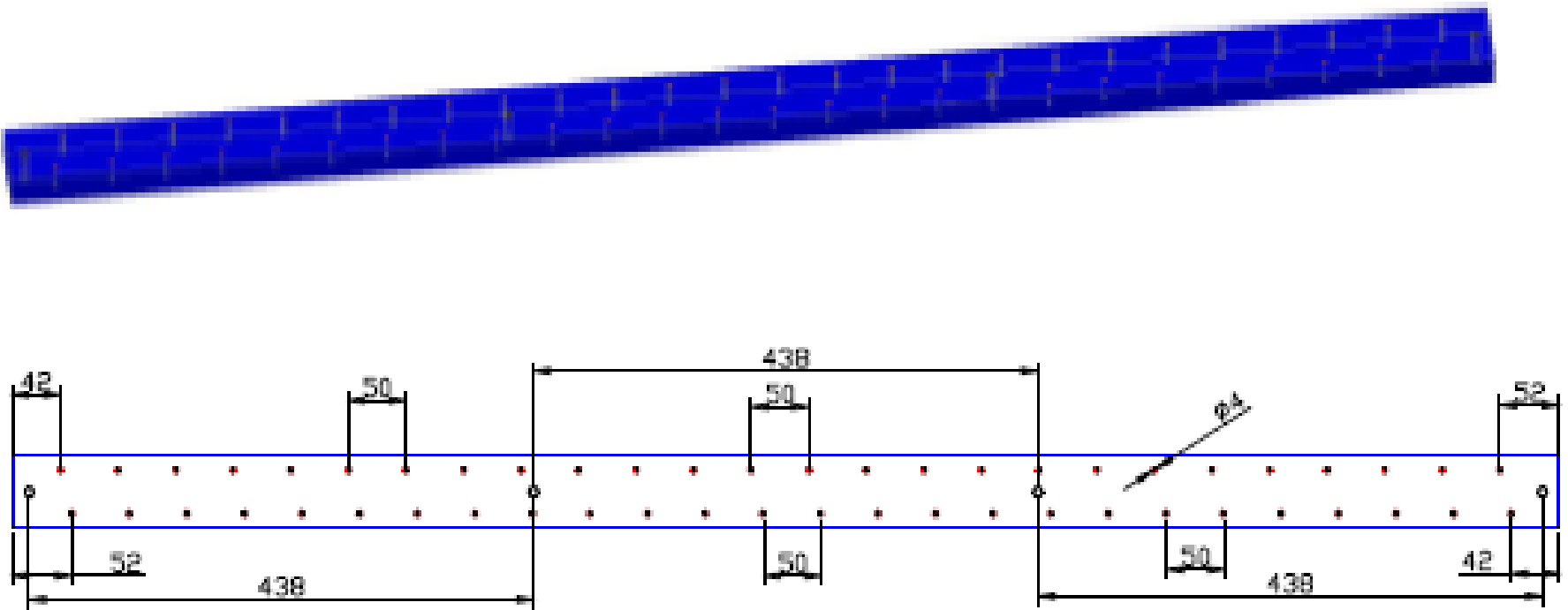

Ny nifiny

Ny nanamboarana ny fitovana dia azo tamina vy boribory $\text{\O}4\text{mm}$ ary 150mm ny halavany, naforitra mba hitovy amin'ny litera V ,15mm ny halavany milentika ao amin'ny hazo

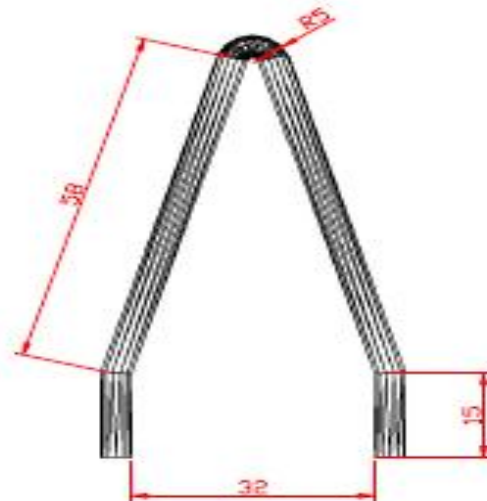
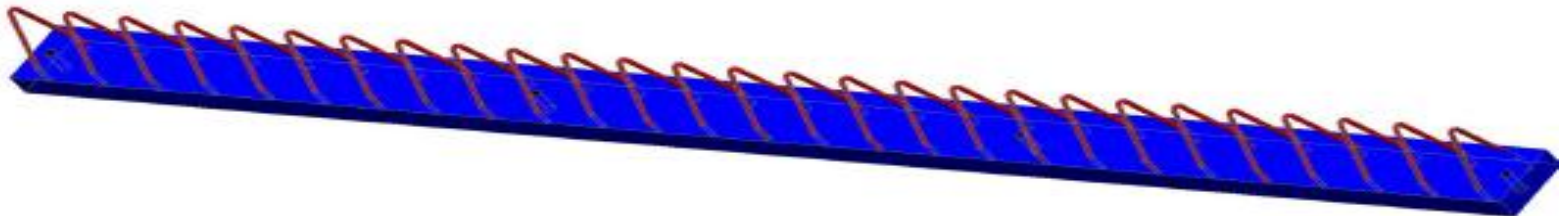

Ny « Cerceau »

Eo amin`ny fanamboarana ity « Cerceau » ity dia maka vy fisaka mirefy 1135mm ny halavany ary sakany 40mm manana hatevenana 4mm; rehefa avy eo dia loahana amin`ny masiny mba ahafahana mametaka ny hazo mitondra ny « nifinifiny »

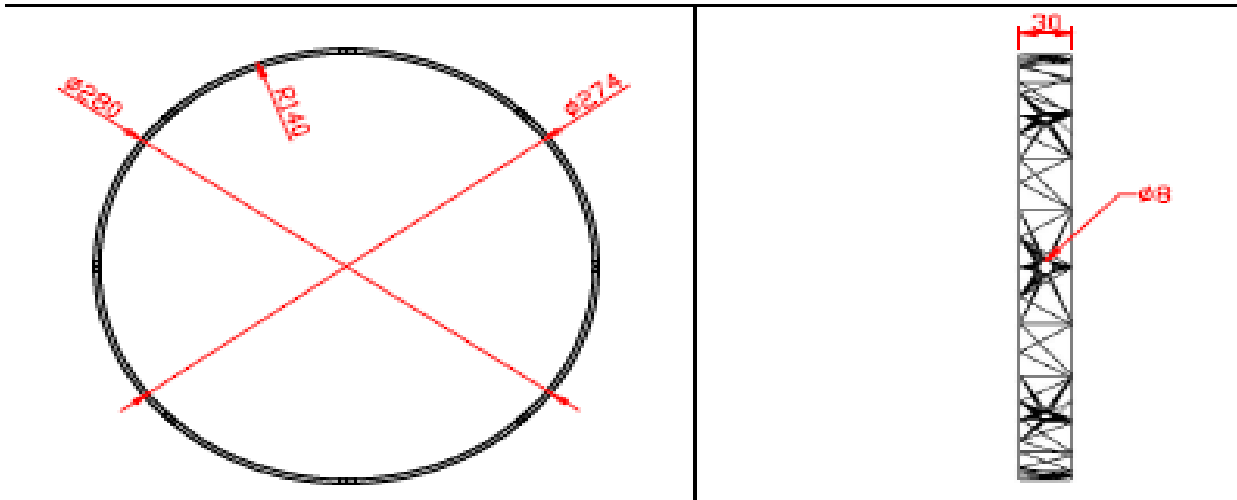
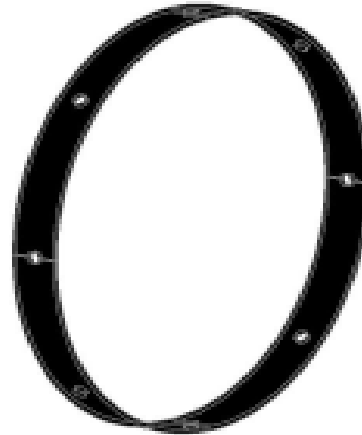

« Rayon»-n`ny « Cerceau »

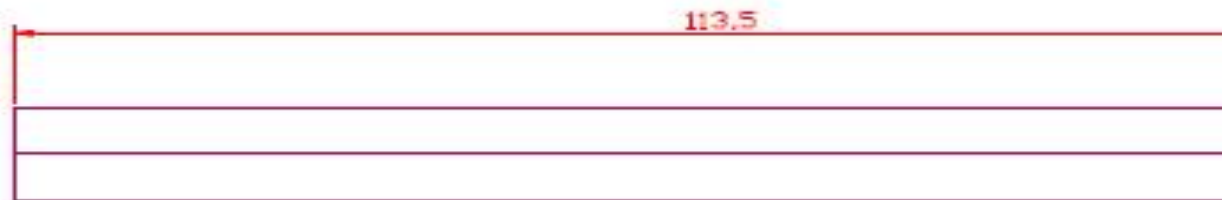

Ny « Bague »

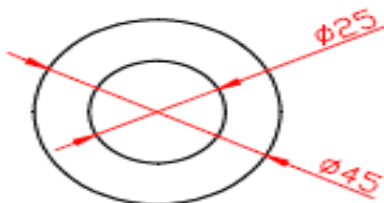
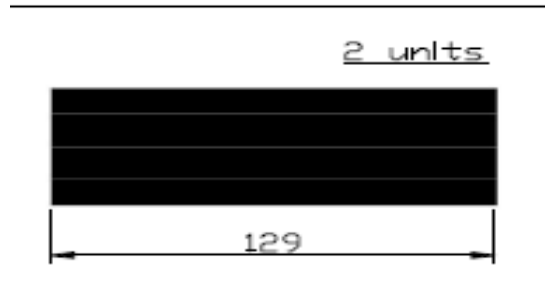
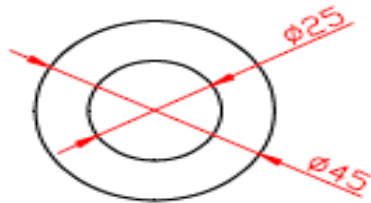
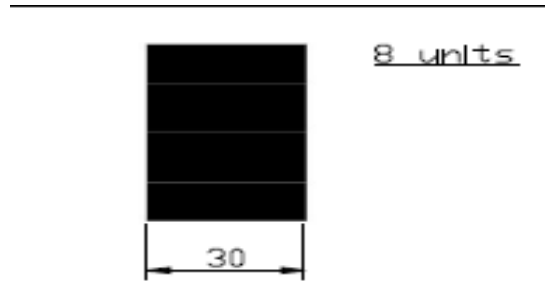

Ny « Bague » dia vita amin`ny vy boribory manana savaivo $\phi 45$ mm, nolavahina $\phi 25$ mm araky ny hita eo amin`ny sary.

Ny « Cage à roulement »

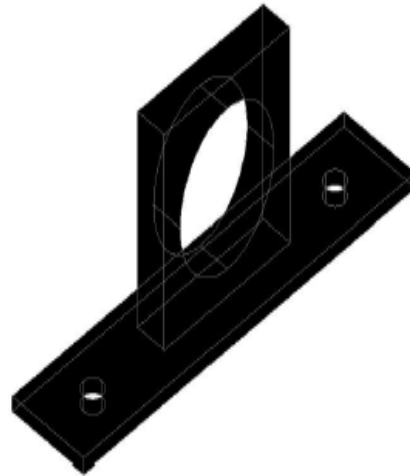
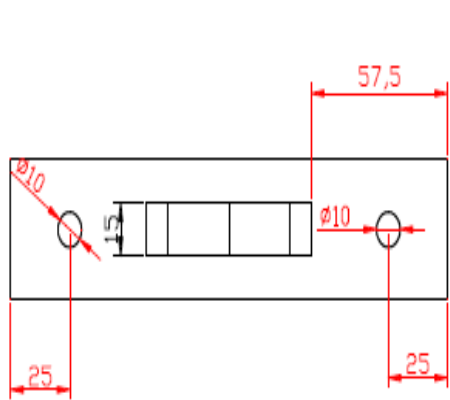

NY « cage à roulement » dia natao itoeran`ny « Roulement », vita amin`ny vy fisaka ary matevina izy, ary namboarina tamin`ny « Tour parallèle ». Izy dia fitambarana vy Roa samy hafa ary avy eo dia natambatra tamin`ny Soudure electrique, araka ny asehon`ny sary.

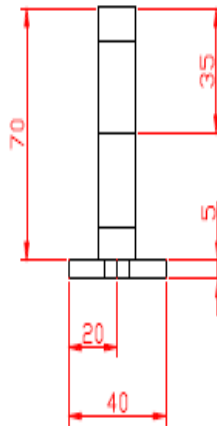
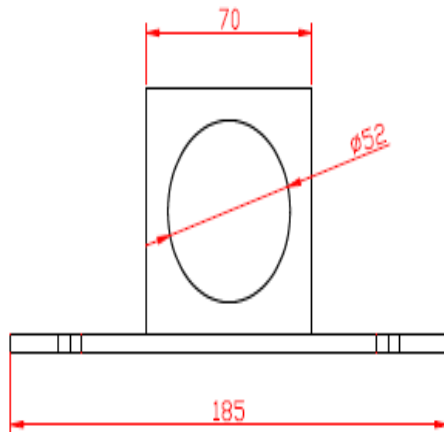

Pale

Ny « Pale » dia vita amin`ny vy avokoa, ary natao hanamora sy hanafaingana ny fivoahan`ny mololo.

FAN

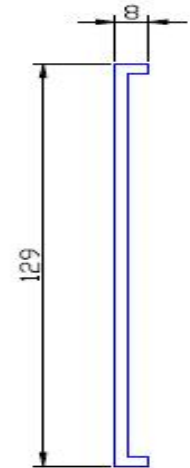
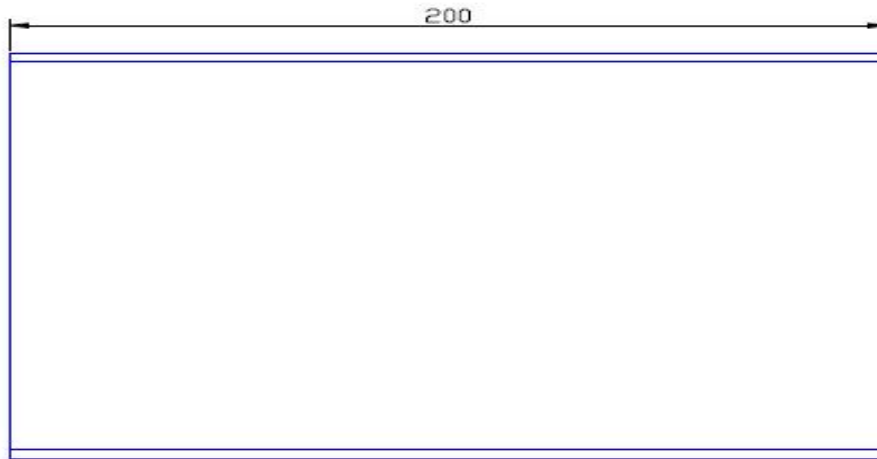
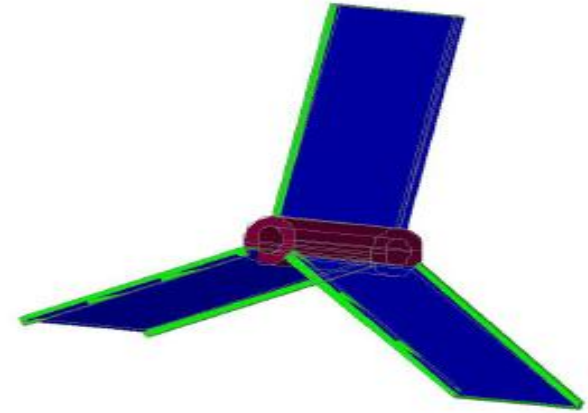
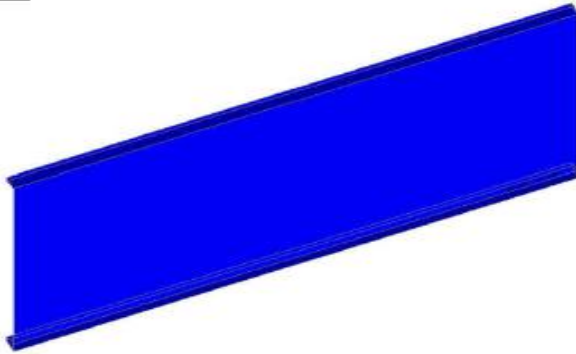

TPG 10/10 : 3 unit

Poulie

Vita amin`ny «Jente »-na bisikileta ary vy fisaka ity « poulie » ity



Pulley



Flat 20 x 2 : 2 units

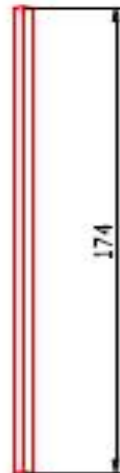
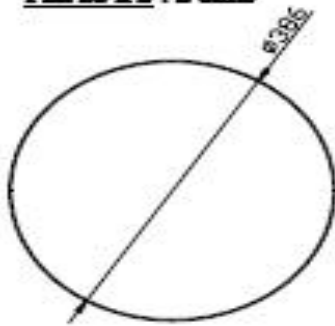

round iron Ø 6 : 12 units

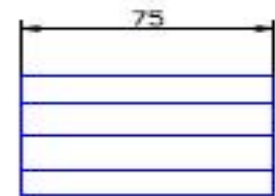
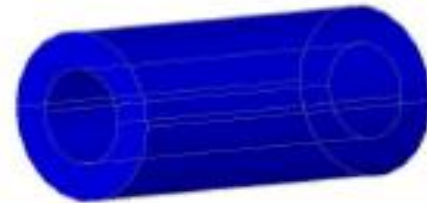

2 units

Ny tanjaky ny sarony

COVER FRAME 1

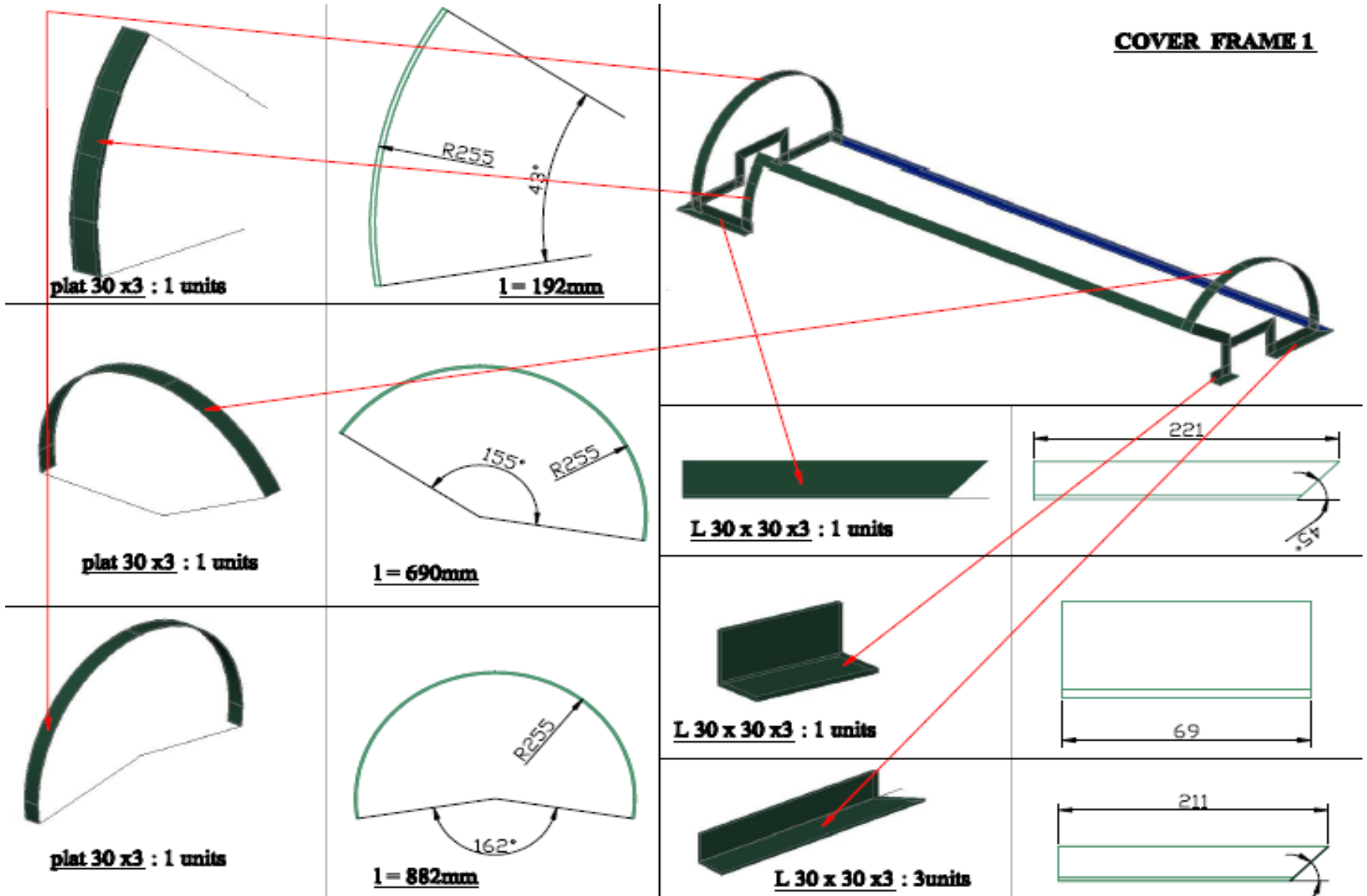

Ny sarony

SIDE COVER

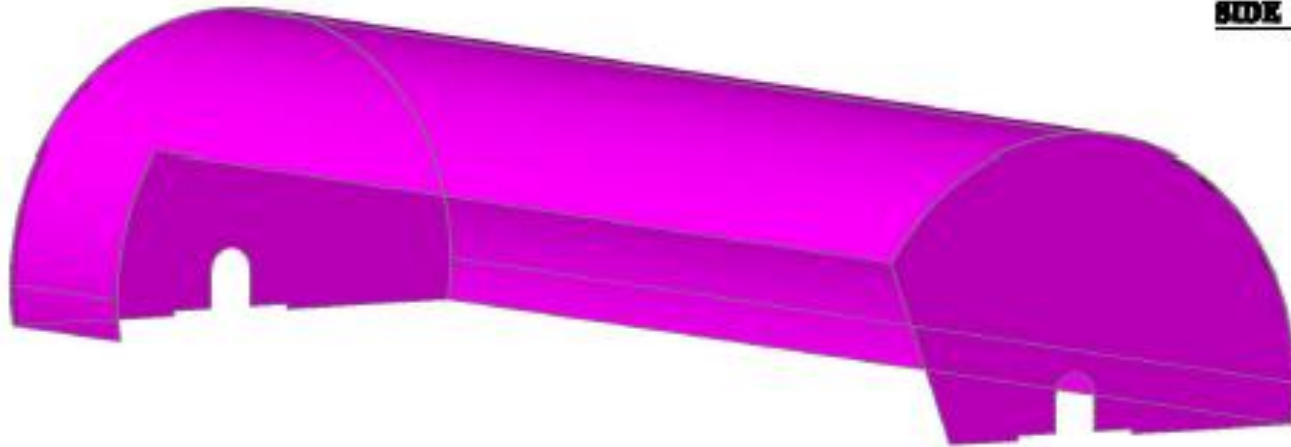

TPG 5/10 : 1 unit

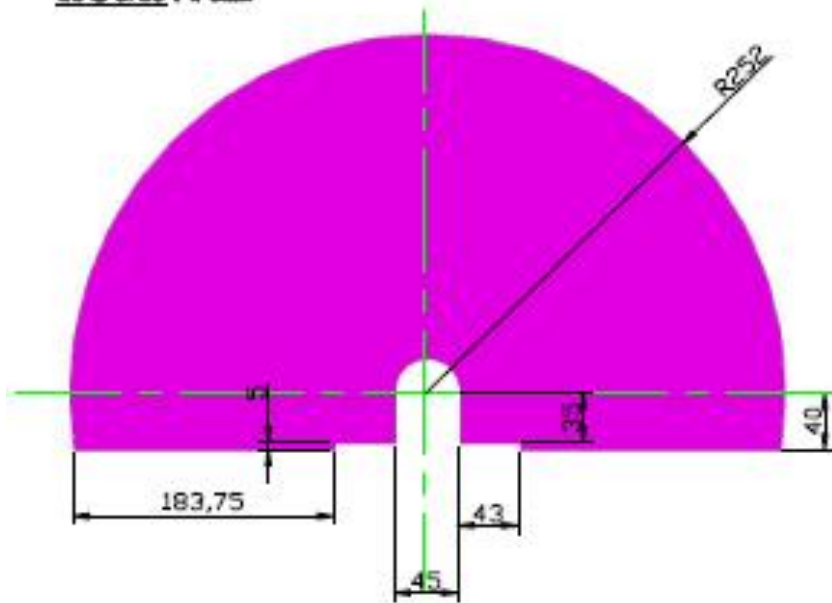

TPG 5/10 : 1 unit

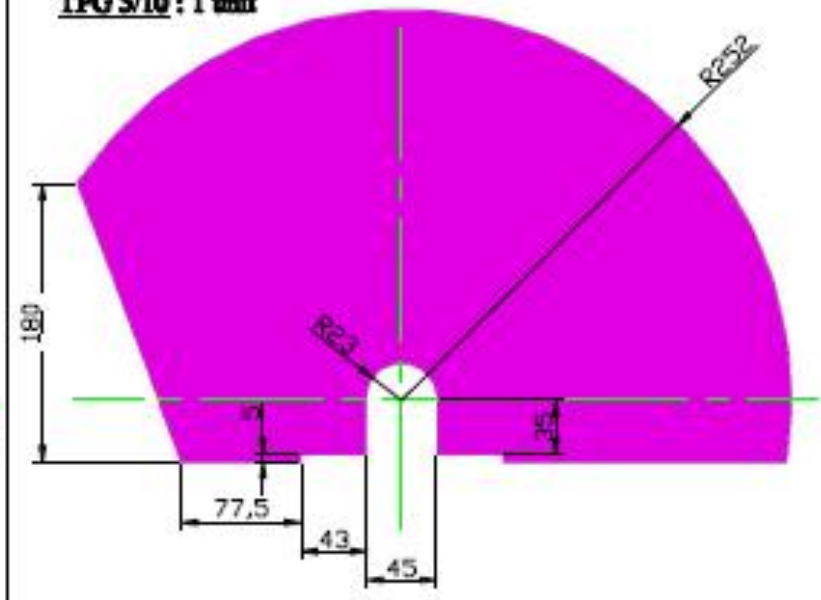

Ny « Concave »



plat 30 x3 : 2 units

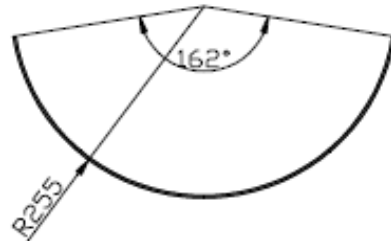

l = 721mm

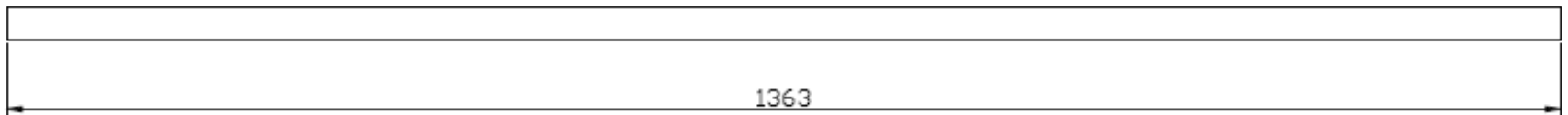

plat 30 x3 : 2 units

Ny fivoahan`ny mololo

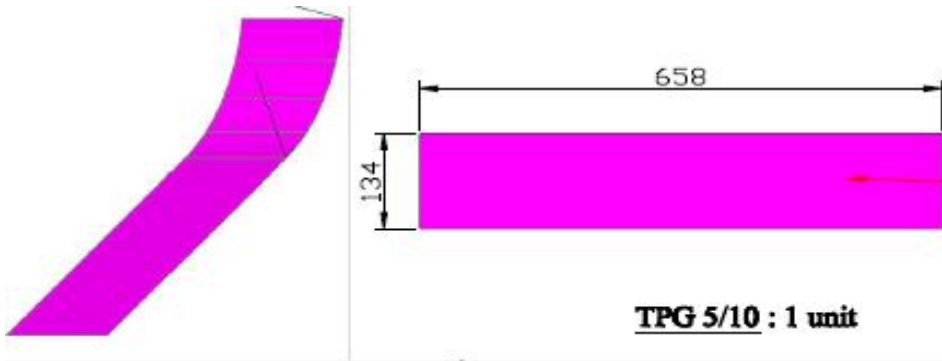

STRAW OUTLET

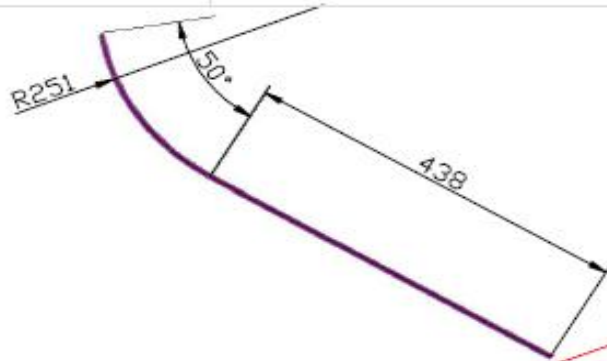
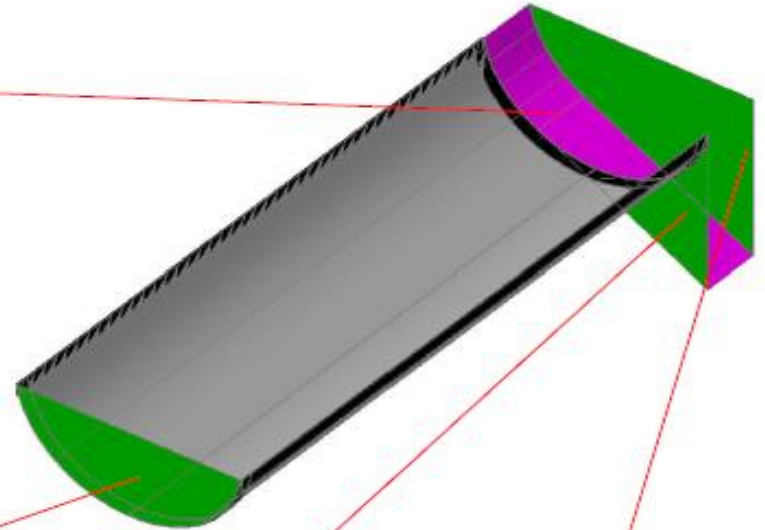

TPG 5/10 : 1 unit

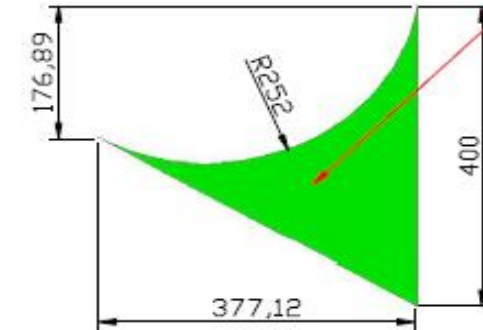
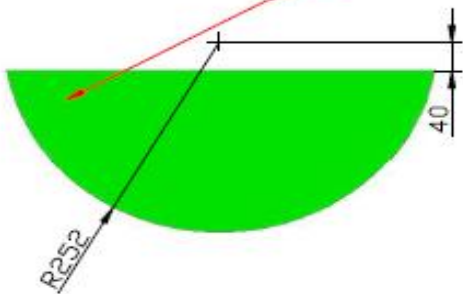

TPG 5/10 : 1 unit

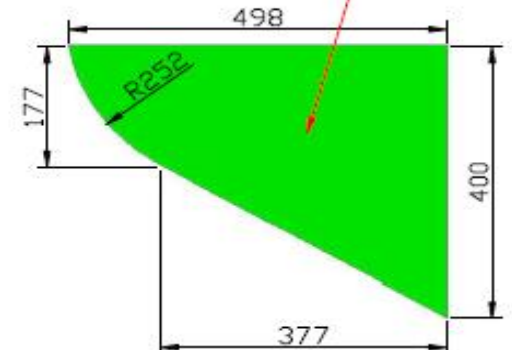

TPG 5/10 : 1 unit

Ny Tanjaky ny fivoahan`ny voam-bary

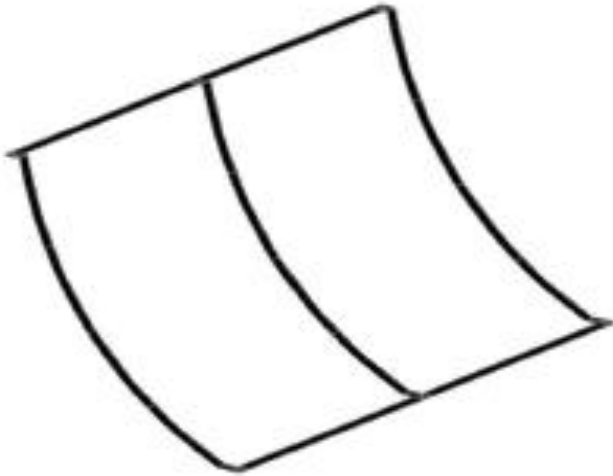

BOTTOM COVER
(frame)

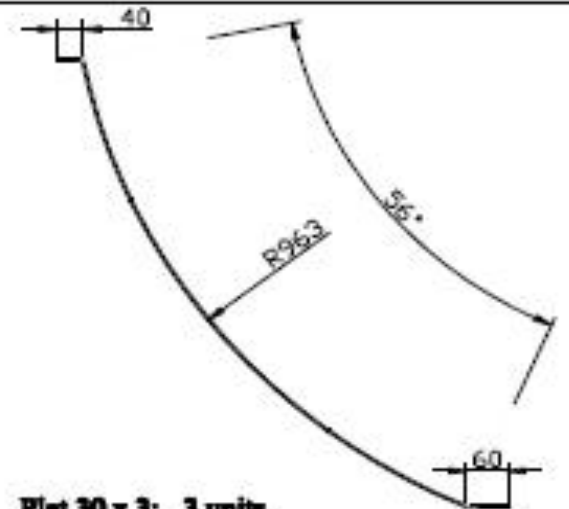
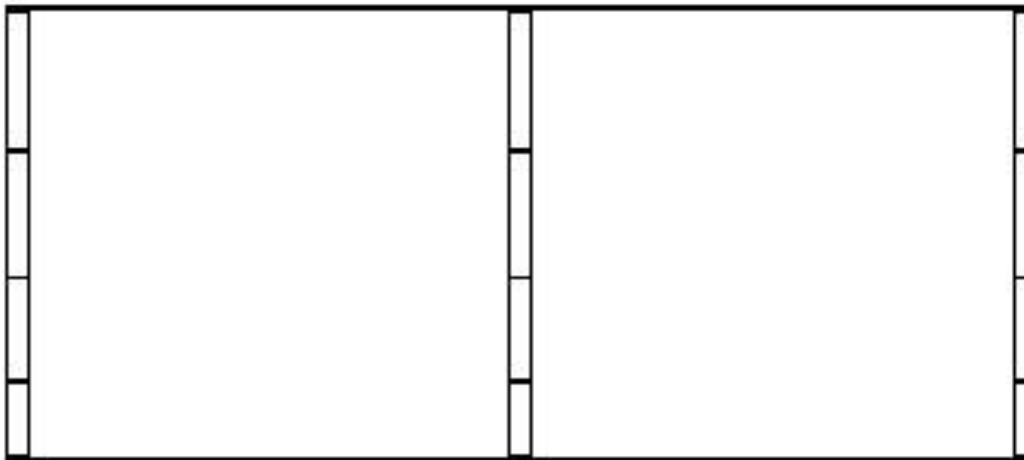
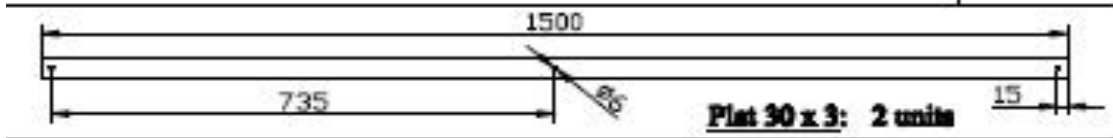
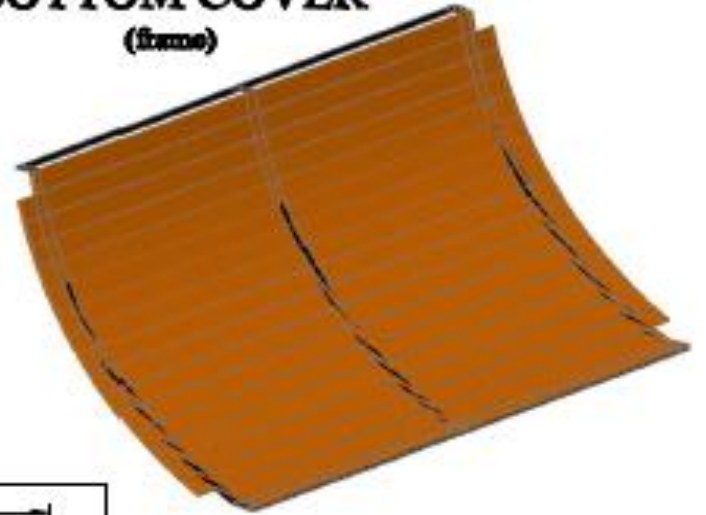

Ny fivoahan`ny voam-bary

bottom cover
(wood)



15 units

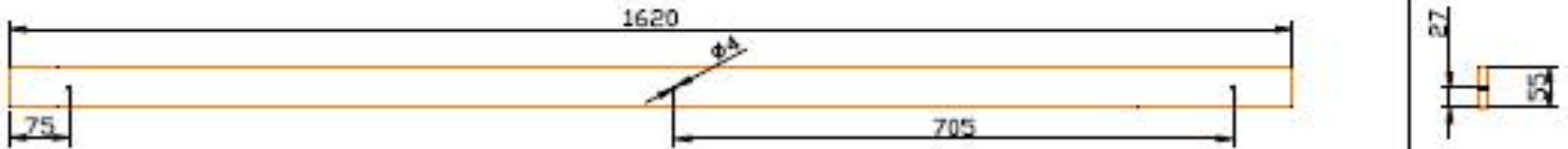

3 units

