

DAILY CHECK AIR POLLUTION MONTH: July-2024

Kubota Construction Co., Ltd

No.	Location	Point Sta	Describe Working	Air Pollution Level	HCHO (µg/m3)	TVOC (µg/m3)	PM 2.5 (µg/m3)	PM 1 (µg/m3)	PM 10 (µg/m3)	Temp (°C)	Humidity (%)	Date (DD/MM/YY)	Time (h:mm)
(1)	(2)	(3)	(4)	(5)	(6)	(7)	(8)	(9)	(10)	(11)	(12)	(13)	(14)
01	Flocculation Basin	A	Handrail installation and welding	002 (Fresh)	0.014	0.058	006	004	006	31.0	71.0	3-Jul-2024	15:07
02	New Reservoir	B	Soil Removal	005 (Fresh)	0.034	0.144	005	003	005	33.0	59.0	3-Jul-2024	15:25
03	LN6-1	1+250	Sub-base Compaction	003 (Fresh)	0.029	0.125	009	006	010	30.0	68.0	3-Jul-2024	9:59
04	WTP	A	Soil Leveling	008 (Fresh)	0.028	0.117	021	015	024	29.0	78.0	10-Jul-2024	15:01
05	New Reservoir	B	Fence and Drainage Construction	008 (Fresh)	0.043	0.177	010	007	011	33.0	64.0	10-Jul-2024	15:21
06	LN6-1	1+325	Apply Primecoat	003 (Fresh)	0.014	0.058	009	006	010	32.0	64.0	11-Jul-2024	10:08
07	LN10-1	0+125	Road Maintenance	002 (Fresh)	0.028	0.117	006	004	006	36.0	52.0	11-Jul-2024	10:22
08	Receiving & Mixing Well	A	Clean-up	004 (Fresh)	0.014	0.059	010	007	011	33.0	65.0	14-Jul-2024	10:23
09	New Reservoir	B	Basecourse Compaction	004 (Fresh)	0.032	0.132	006	004	006	34.0	61.0	14-Jul-2024	10:57
10	LN6-1	1+325	Placing Basecourse	004 (Fresh)	0.010	0.050	010	007	011	32.0	67.0	14-Jul-2024	10:20
11	LN6-1	1+450	Basecourse Compaction	004 (Fresh)	0.009	0.038	012	009	013	35.0	59.0	14-Jul-2024	10:26
12	WTP	A	Basecourse Compaction	014 (Fresh)	0.058	0.248	002	001	002	37.0	48.0	17-Jul-2024	11:38
13	New Reservoir	B	Apply Primecoat	009 (Fresh)	0.047	0.203	004	003	004	34.0	57.0	17-Jul-2024	11:20
14	LN6-1	1+150	Repairing Road	007 (Fresh)	0.040	0.173	009	006	10.0	32.0	61.0	17-Jul-2024	10:48
15	LN6-1	1+950	Repairing Basecourse	004 (Fresh)	0.031	0.131	006	004	006	33.0	62.0	17-Jul-2024	10:54
16	LN18-1	1+500	Basecourse Compaction	002 (Fresh)	0.028	0.118	005	003	005	35.0	52.0	17-Jul-2024	11:09
17	WTP	A	Soil Leveling	011 (Fresh)	0.051	0.225	006	004	006	28.0	77.0	22-Jul-2024	15:02
18	New Reservoir	B	Finishing Wall	010 (Fresh)	0.048	0.194	003	002	003	33.0	60.0	22-Jul-2024	15:44
19	LN6-1	1+000	DBST Pavement	011 (Fresh)	0.050	0.209	006	004	006	34.0	58.0	22-Jul-2024	15:28
20	WTP	A	Pouring Concrete Pavement of Entrance Gate	011 (Fresh)	0.051	0.220	010	007	011	28.0	73.0	28-Jul-2024	14:23
21	New Reservoir	B	Condition after Construction	013 (Fresh)	0.056	0.246	005	003	005	33.0	58.0	28-Jul-2024	14:31
22	LN11-2	2+600	Preparing Paving DBST 2nd Layer	007 (Fresh)	0.039	0.164	004	003	004	38.0	49.0	28-Jul-2024	14:55
23	LN18-1	0+200	Paving DBST 2nd Layer	005 (Fresh)	0.034	0.147	006	004	006	36.0	53.0	28-Jul-2024	14:47

Reservoir Check Point

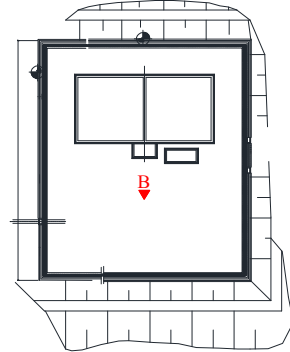

Water treatment plant and Stockyard Check Point

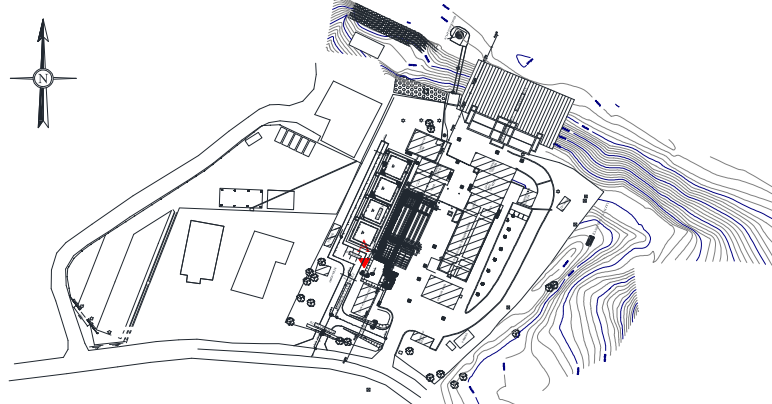

Pipeline Check Point Working Site LN.

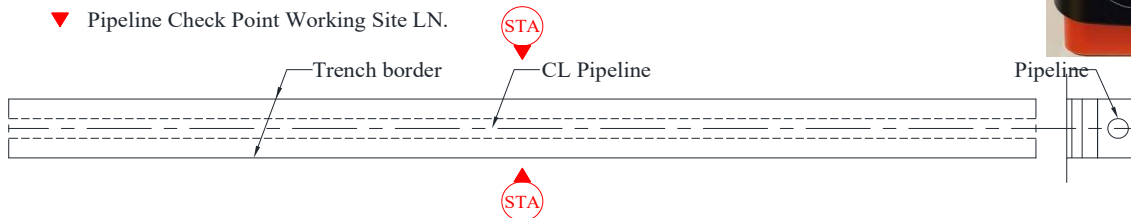

THE PROJECT FOR THE EXPANSION OF WATER SUPPLY SYSTEM IN LUANG PRABANG CITY
DAILY CHECK SOUND LEVEL MONTH: July-2024 (Mechanical Noise-Among 10m)
(RION SOUND LEVEL METER NL-42A)

Kubota Construction Co., Ltd

No.	Location	Point Sta	Describe Working	Sound		Level	Date (DD/MM/YY)	Time (h:mm)	Remarks
				Max (dB)	Min (dB)				
(1)	(2)	(3)	(4)	(5)	(6)	(7)	(8)	(9)	(10)
01	Flocculation Basin	A	Handrail installation and welding	67.4	50.3	Lo	3-Jul-2024	15:08	
02	New Reservoir	B	Soil Removal	56.3	49.8	Lo	3-Jul-2024	15:26	
03	LN6-1	1+250	Sub-base Compaction	70.8	58.2	Lo	3-Jul-2024	10:00	
04	WTP	A	Soil Leveling	63.2	53.6	Lo	10-Jul-2024	15:02	
05	New Reservoir	B	Fence and Drainage Construction	74.3	65.4	Lo	10-Jul-2024	15:22	
06	LN6-1	1+325	Apply Primecoat	56.8	41.1	Lo	11-Jul-2024	10:09	
07	LN10-1	0+125	Road Maintenance	59.8	57.1	Lo	11-Jul-2024	10:23	
08	Receiving & Mixing Well	A	Clean-up	61.3	49.9	Lo	14-Jul-2024	10:24	
09	New Reservoir	B	Basecourse Compaction	65.2	46.9	Lo	14-Jul-2024	10:58	
10	LN6-1	1+325	Placing Basecourse	76.7	64.2	Lo	14-Jul-2024	10:21	
11	LN6-1	1+450	Basecourse Compaction	76.3	65.5	Lo	14-Jul-2024	10:27	
12	WTP	A	Basecourse Compaction	67.1	51.3	Lo	17-Jul-2024	11:39	
13	New Reservoir	B	Apply Primecoat	20.2	43.4	Lo	17-Jul-2024	11:21	
14	LN6-1	1+150	Repairing Road	64.1	57.6	Lo	17-Jul-2024	10:49	
15	LN6-1	1+950	Repairing Basecourse	80.5	68.7	Lo	17-Jul-2024	10:55	
16	LN18-1	1+500	Basecourse Compaction	76.0	69.8	Lo	17-Jul-2024	11:10	
17	WTP	A	Soil Leveling	73.6	43.5	Lo	22-Jul-2024	15:03	
18	New Reservoir	B	Finishing Wall	70.4	45.1	Lo	22-Jul-2024	15:45	
19	LN6-1	1+000	DBST Pavement	79.0	66.2	Lo	22-Jul-2024	15:29	
20	WTP	A	Pouring Concrete Pavement of Entrance Gate	75.5	54.4	Lo	28-Jul-2024	14:24	
21	New Reservoir	B	Condition after Construction	68.9	55.4	Lo	28-Jul-2024	14:32	
22	LN11-2	2+600	Preparing Paving DBST 2nd Layer	75.7	65.3	Lo	28-Jul-2024	14:56	
23	LN18-1	0+200	Paving DBST 2nd Layer	74.4	66.0	Lo	28-Jul-2024	14:48	

▼ Reservoir Check Point

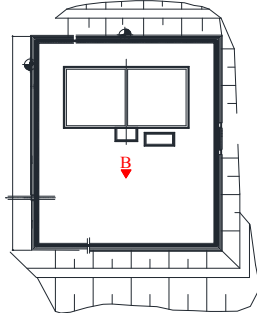

▼ Water treatment plant and Stockyard Check Point

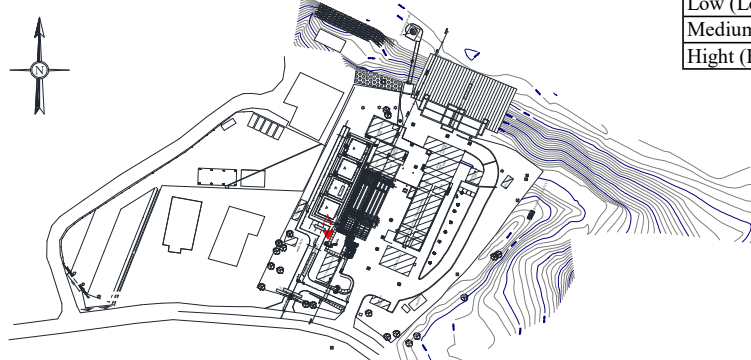

Low (Lo)	30~80> dB	
Medium (Med)	80~130 dB	
High (Hi)	130< dB	

▼ Pipeline Check Point Working Site LN.

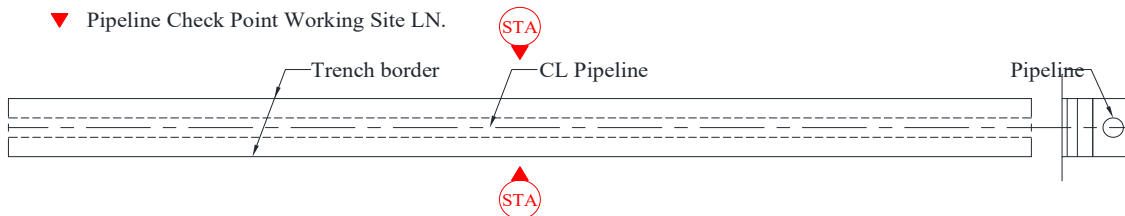

DAILY CHECK VIBRATION LEVEL MONTH: July-2024

(RION Vibration Level Meter VM-55)

Kubota Construction Co., Ltd

No.	Location	Point Sta	Describe Working	Frequency (Hz)	Level Velocity [Lv], (dB)	Level Acceleration [Lva], (dB)	Date (DD/MM/YY)	Time (h:mm)	Remarks
(1)	(3)	(2)	(4)	(5)	(6)	(7)	(8)	(9)	(10)
01	Flocculation Basin	A	Handrail installation and welding		29.1	50.1	3-Jul-2024	15:09	
02	New Reservoir	B	Soil Removal		16.8	24.4	3-Jul-2024	15:27	
03	LN6-1	1+250	Sub-base Compaction		13.5	35.2	3-Jul-2024	10:01	
04	WTP	A	Soil Leveling		27.9	49.0	10-Jul-2024	15:03	
05	New Reservoir	B	Fence and Drainage Construction		10.1	27.4	10-Jul-2024	15:23	
06	LN6-1	1+325	Apply Primecoat		20.2	39.8	11-Jul-2024	10:10	
07	LN10-1	0+125	Road Maintenance		32.5	47.2	11-Jul-2024	10:24	
08	Receiving & Mixing Well	A	Clean-up		24.4	51.7	14-Jul-2024	10:25	
09	New Reservoir	B	Basecourse Compaction		48.0	73.3	14-Jul-2024	10:59	
10	LN6-1	1+325	Placing Basecourse		19.0	30.3	14-Jul-2024	10:22	
11	LN6-1	1+450	Basecourse Compaction		52.7	57.5	14-Jul-2024	10:28	
12	WTP	A	Basecourse Compaction		20.5	47.7	17-Jul-2024	11:40	
13	New Reservoir	B	Apply Primecoat		74.7	66.0	17-Jul-2024	11:22	
14	LN6-1	1+150	Repairing Road		16.9	38.9	17-Jul-2024	10:50	
15	LN6-1	1+950	Repairing Basecourse		50.7	80.2	17-Jul-2024	10:56	
16	LN18-1	1+500	Basecourse Compaction		21.4	41.1	17-Jul-2024	11:11	
17	WTP	A	Soil Leveling		38.9	60.9	22-Jul-2024	15:04	
18	New Reservoir	B	Finishing Wall		17.9	25.3	22-Jul-2024	15:46	
19	LN6-1	1+000	DBST Pavement		23.1	41.0	22-Jul-2024	15:30	
20	WTP	A	Pouring Concrete Pavement of Entrance Gate		17.7	36.1	28-Jul-2024	14:25	
21	New Reservoir	B	Condition after Construction		17.5	25.5	28-Jul-2024	14:33	
22	LN11-2	2+600	Preparing Paving DBST 2nd Layer		22.9	44.7	28-Jul-2024	14:57	
23	LN18-1	0+200	Paving DBST 2nd Layer		19.5	34.7	28-Jul-2024	14:49	

▼ Reservoir Check Point

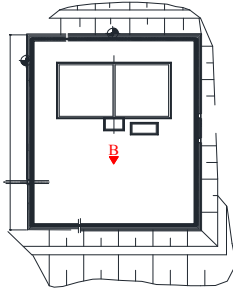

▼ Water treatment plant and Stockyard Check Point

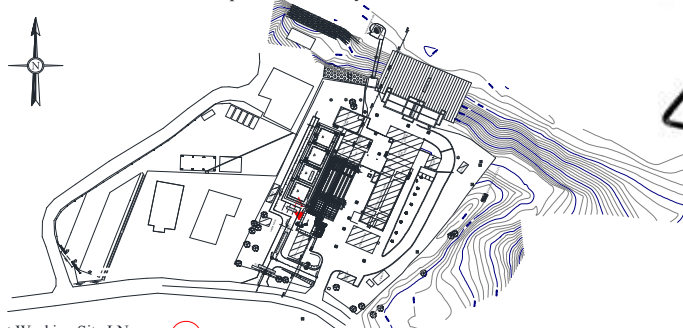

▼ Pipeline Check Point Working Site LN.

