



**Torolalana momban`ny fomba fanamboarana ny
FIKAPOHAM-BARY VOIZINA AN-TONGOTRA**



**MINISTERAN`NY FAMBOLENA REPOBLIKAN`NY MADAGASIKARA
DIRECTION REGIONALE DU DEVELOPPEMENT RURAL (DRDR)
JAPAN INTERNATIONAL COOPERATION AGENCY (JICA)
CENTRE DE FORMATION ET D`APPLICATION DU MACHINISME AGRICOLE
MINISTRY OF AGRICULTURAL REPUBLIC OF INDONESIA**



2010

FIKAPOHAM-BARY VOHIZIN-TONGOTRA

Ny akora ilaina

1. Tube rond \varnothing 25mm
2. Electrode 2,5 mm
3. Pignon moto (iray lehibe ary iray kely)
4. Chaine moto
5. Fer corniere 30 x 30 x 3 mm
6. Fer plat 30 x 3 mm
7. Fer rond \varnothing 10 mm
8. Fer rond \varnothing 4 mm
9. Hazo fisaka
10. Labasy
11. Blao

Ny fitaovana ilaina

1. Poste soudure electrique
2. Marteau
3. Pince universelle
4. Scie a metaux
5. Ebarbeuse(meule)
6. Tour parallele
7. Perceuse
8. Tronconneuse
9. Cisaille
10. Cles

Ny sarin`ny fikapoham`bary

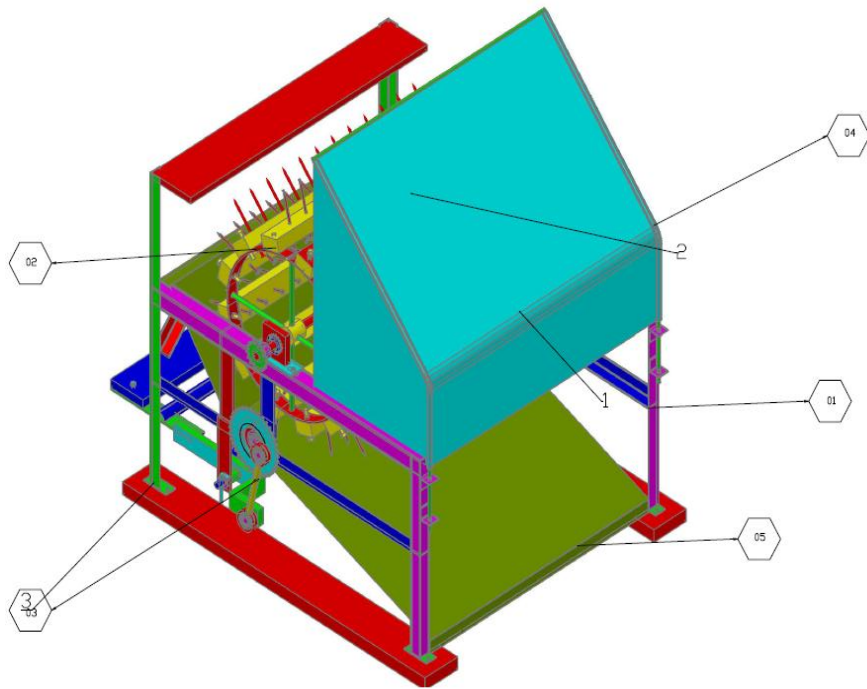

Fanondroana	Akora
1. Faladihy	Hazo
2. Tanjaka	Vy
3. Fivohy	Vy
4. Connecting rod	Vy
5. Transmission	Vy
6. Tamboure	Vy sy Hazo
7. Sortie des grain	Vy fotsy
9. Hazo mitondra ny nify	Hazo
8. Sarony	labasy

Ny fanamboarana ny Fikapoham-bary voizin-tongotra

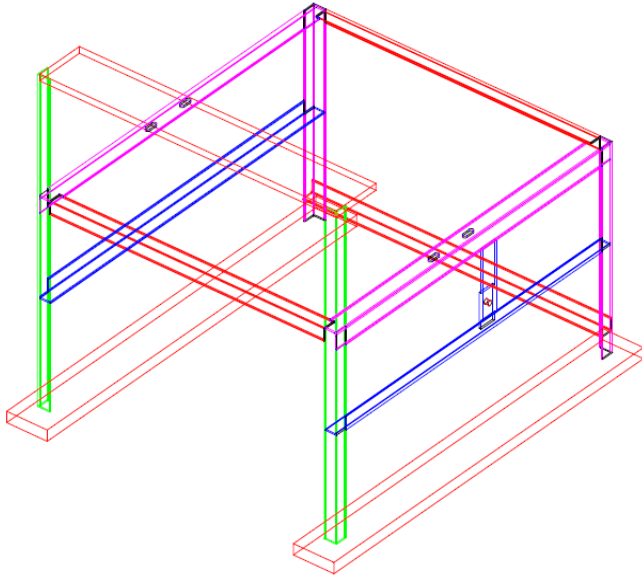

Ny bateuse:

Ny bateuse dia vita avy avy amin`ny akora hita eto an-oerana avokoa, ary ilaina ihany koa ny mampiasa ireo fitaovana voatanisa etsy ambony amin`ny fanamboarana. Ny fanarahana ny “Dessin technique” na ny sary izay efa vita mialohan`ny hanamboarana dia manamora sy manafaingana ny asa fanamboarana. Ohatra amin`izany ny sary izay hita eo ambany.

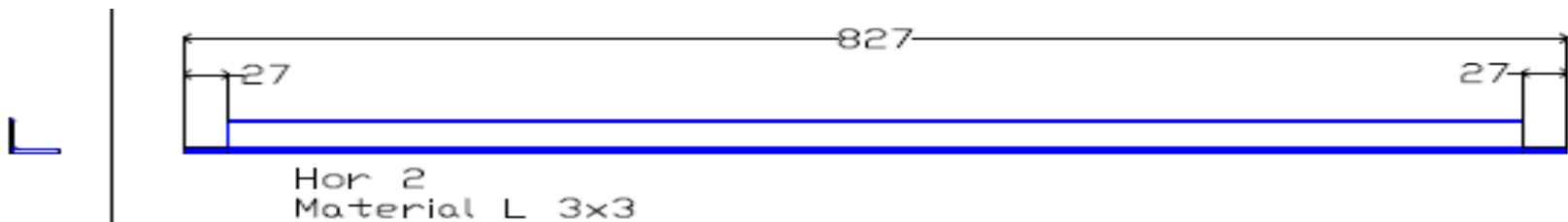

Ny refin`ny tanjaka“bati”

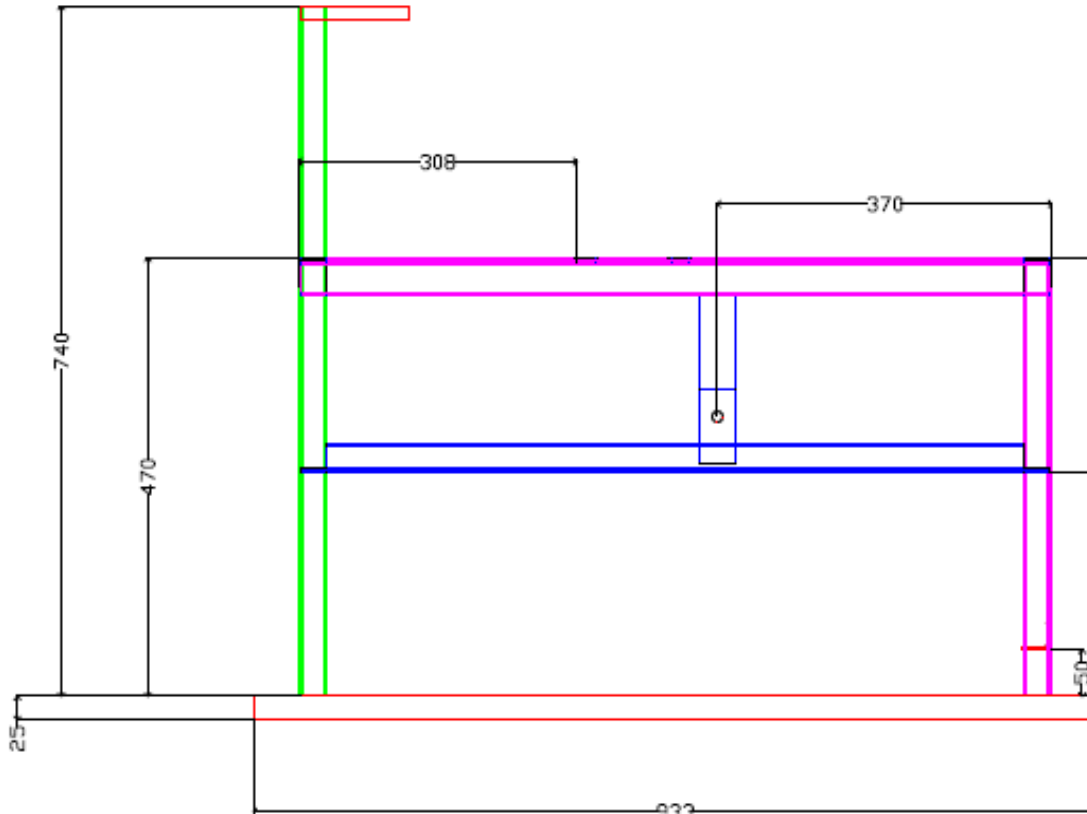

Refiny :

1. Ahavony = 740 mm
2. Halavany = 1200 mm
3. Sakany = 900 mm
4. Lanjany = ± 40 kg

Ny Vy itoeran`ny « Tambour »

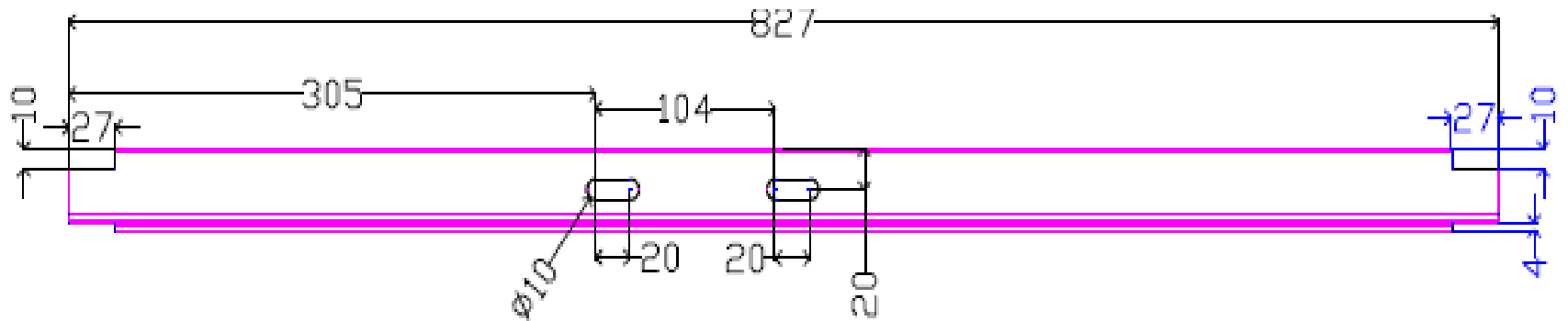

Fer L 40 x 40 x 4mm, hateviny : 4mm, isany: 2

Ny “Tambour”

Ny “Tambour” dia fitambaran`ny:

- Hazo mitondra ny nify « doigt »
- Nify « doigt »
- Cerceau
- Axe
- Bague
- Cage a roulement
- Rayon

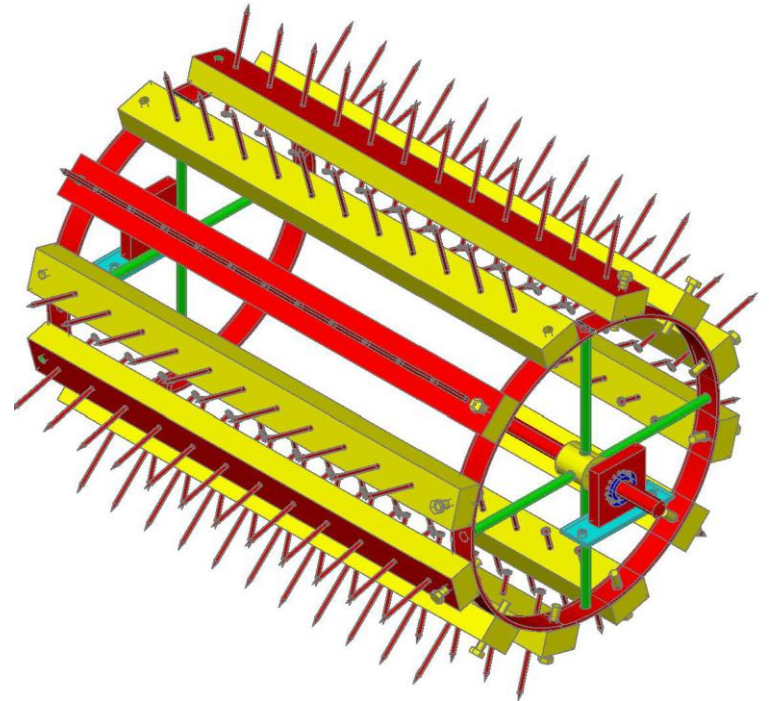

Ny hazo mitondran`ny nify« doigt » sy ny nify

Toy izao ny refin`ny hazo sy ny “doigt”:

- Halavan`ny hazo: 630 mm
- Sakany: 50 mm
- Hateviny: 30 mm
- Isany: 14

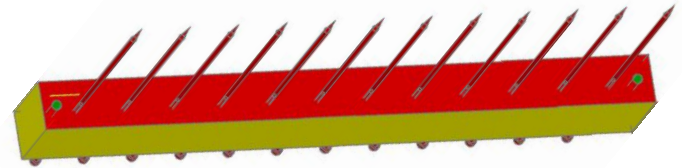

Wood , 50 x 30 mm x 630 mm = 14 units

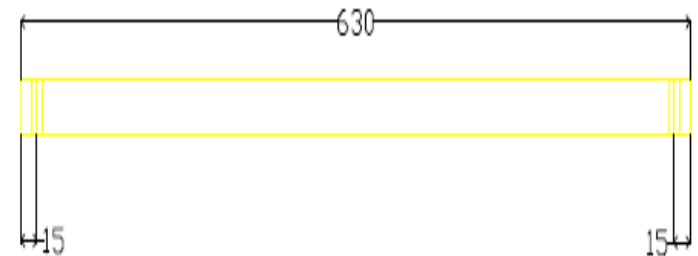
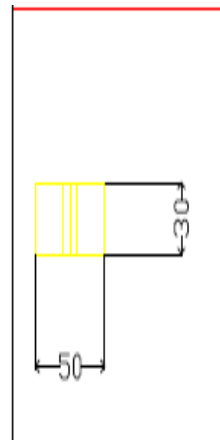
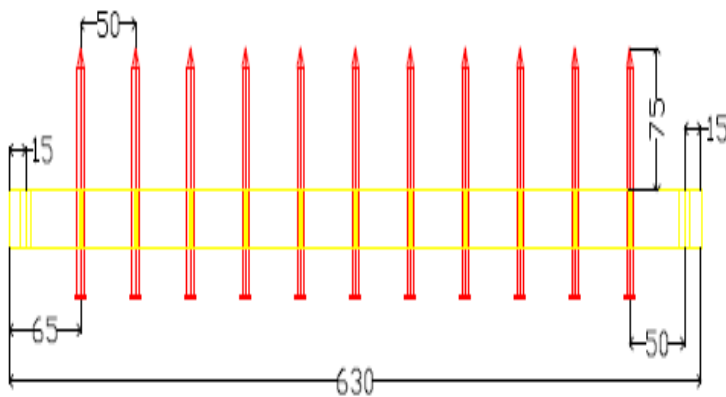

Ny « cerceau » sy ny aksa « Axe »

- Ny « Cerceau » dia vita amin'ny Vy « Fer plat » 30mm x 4mm, nolavahina \varnothing 8mm miisa 12 araka ny hita eo amin'ny sary.

- Ny « Axe » kosa indray dia vita amin'ny vy boribory manana savaivo 20mm, ary manana halavana 800 mm.

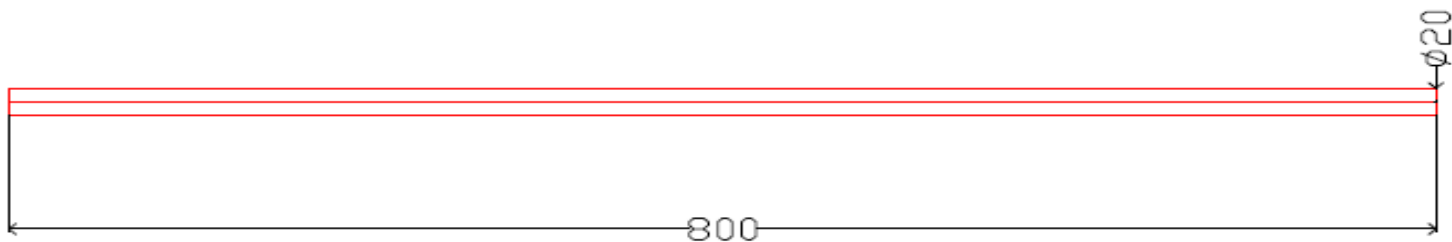
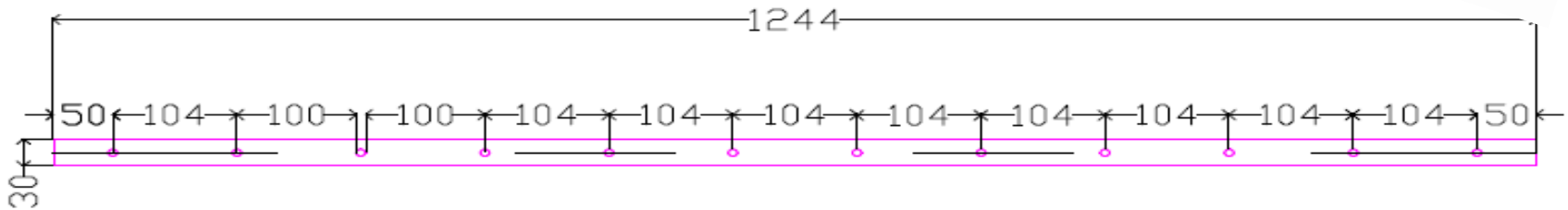
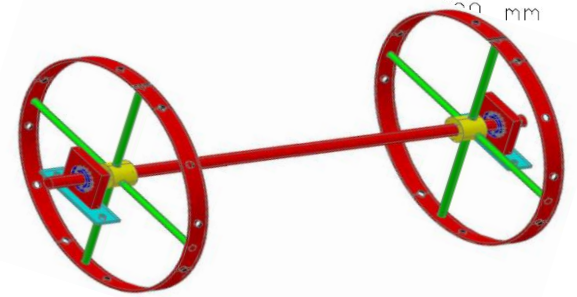

Ny « bague »

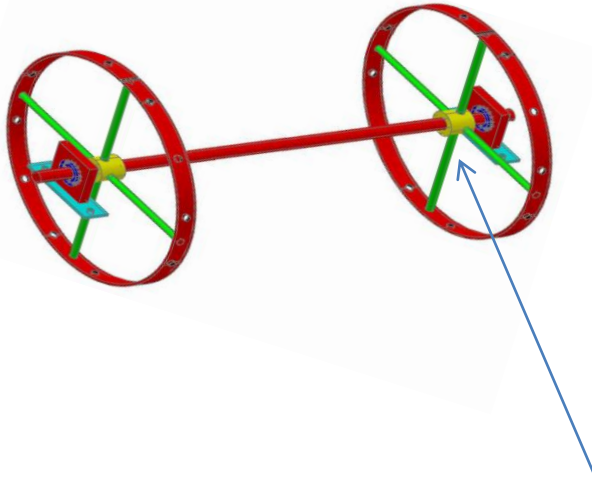

Ny « Bague » dia vita amin`ny vy boribory manana savaivo $\varnothing 40\text{mm}$, nolavahina $\varnothing 20\text{ mm}$ araky ny hita eo amin`ny sary. (miloko mavo)

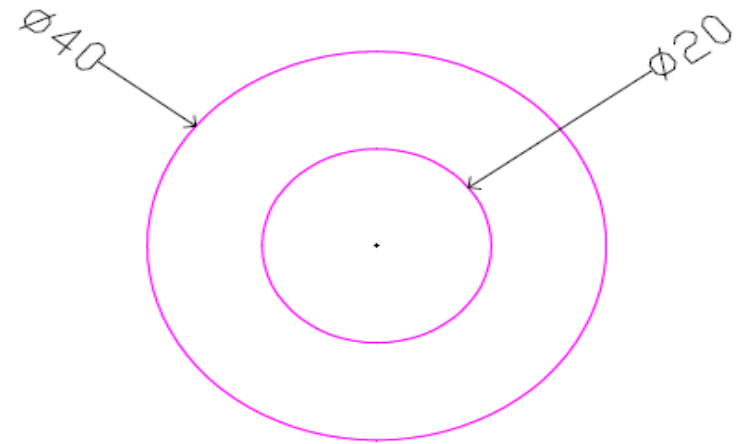
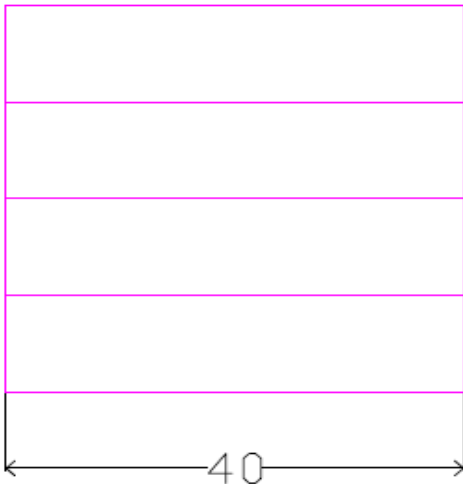

Ny « cage à Roulement »

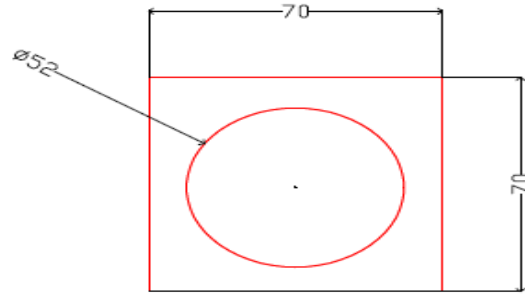

bearing house = 2 unIts

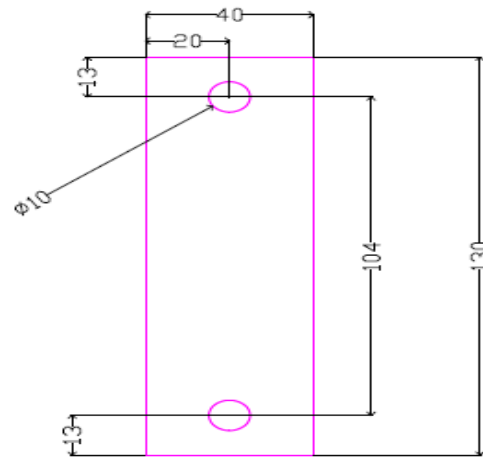

bearing house = 2 unIts

NY « cage a roulement » dia natao itoeran`ny « Roulement », vita amin`ny vy fisaka ary matevina izy, ary namboarina tamin`ny « Tour parallele ». Izy dia fitambarana vy Roa samy hafa ary avy eo dia natambatra tamin`ny Soudure electrique araky ny asehon`ny sary.

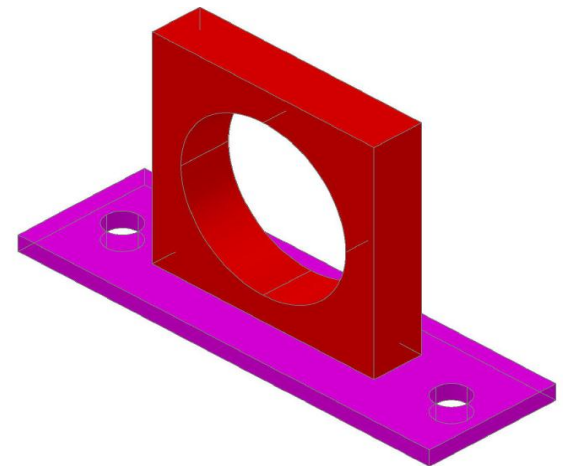

Systeme de transmission

« Cage à roulement » sy Aksa

« Cage á roulement » sy « axe »-n`ny « tige » mampifandray ny « pédale » sy ny « roue dentee » lehibe :

Ity « cage á roulement » ity dia amboarina manokana amin`ny « Tour »

Toy izany koa ny Aksa,

Ny refy rehetra dia hita eo amin`ny sary.

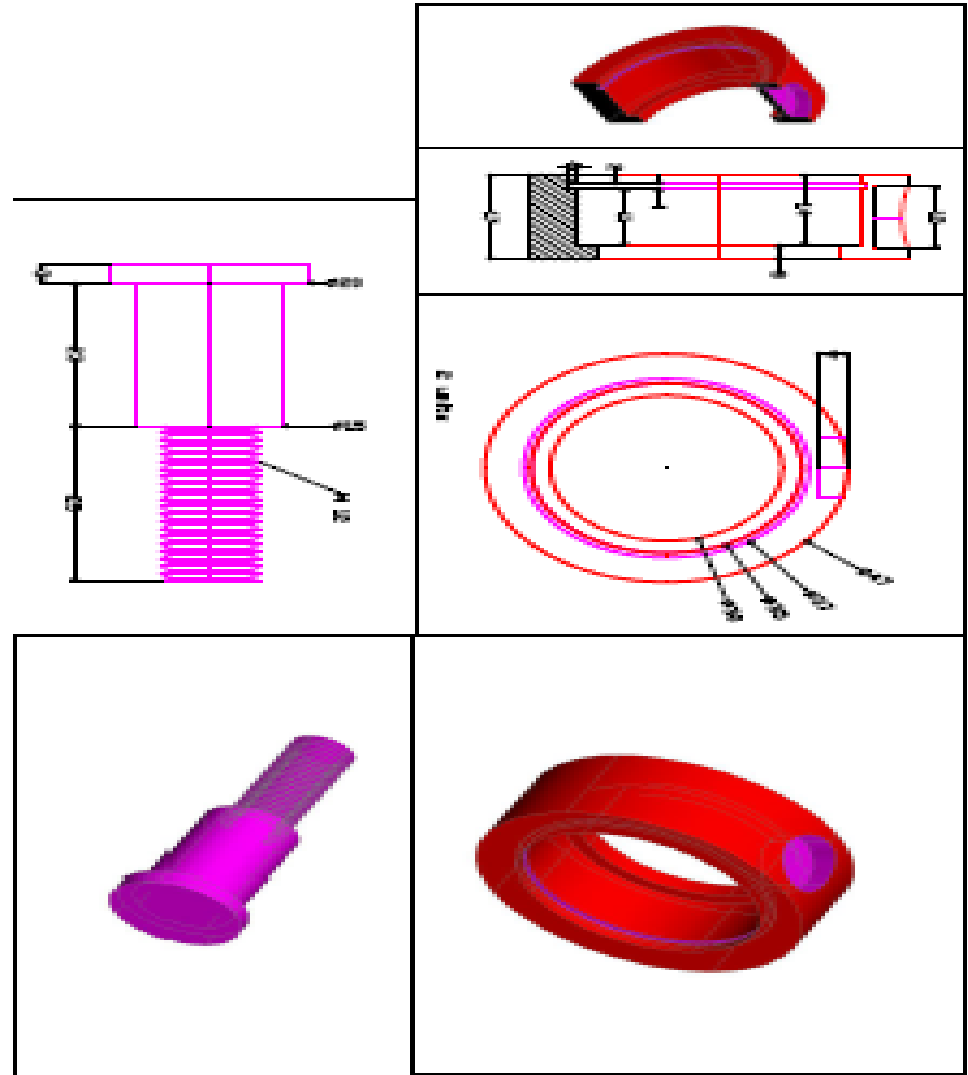

Systeme de transmission

Ny «flasque»

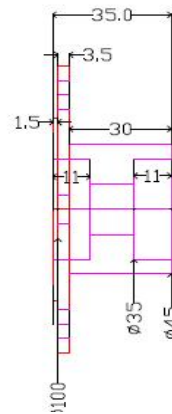
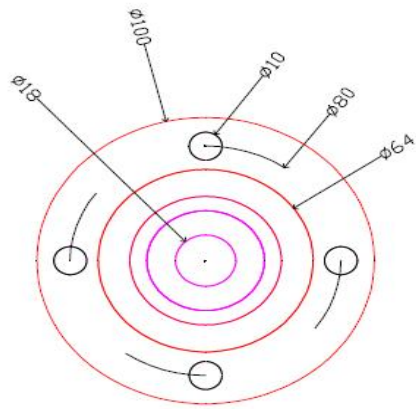
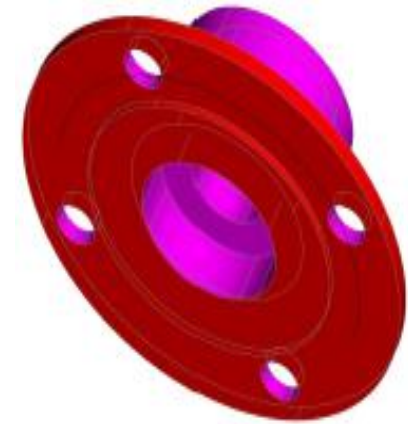
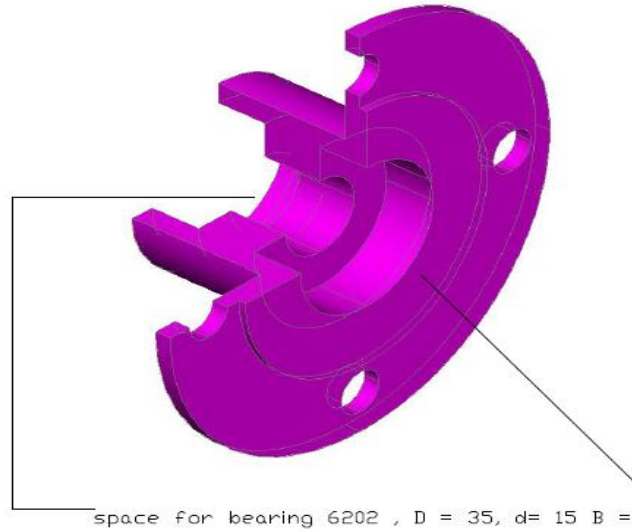

Systeme de transmission

Ny «Pignon» kely

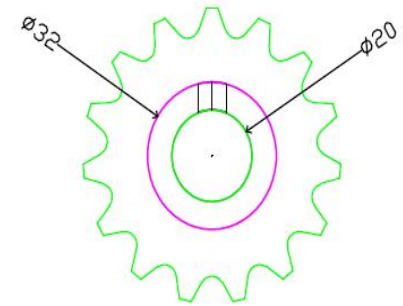
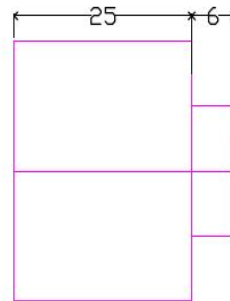
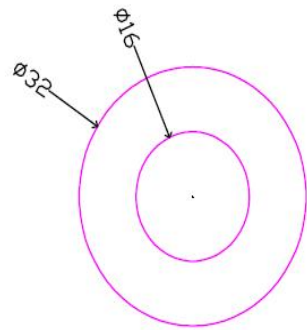
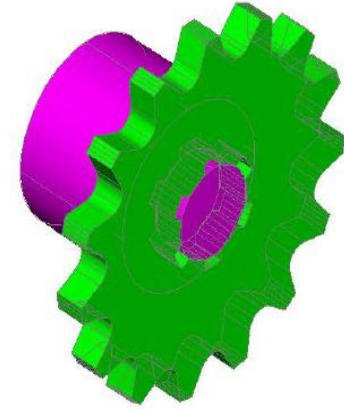
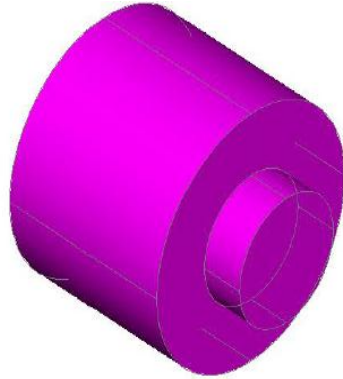

Ny fivoy tongotra «Pedale»

Tige du Pedale: Vita amin`ny « fer plat », ary natao itazona ny pedale, sy ampifandray azy amin`ny « systeme de transmission»

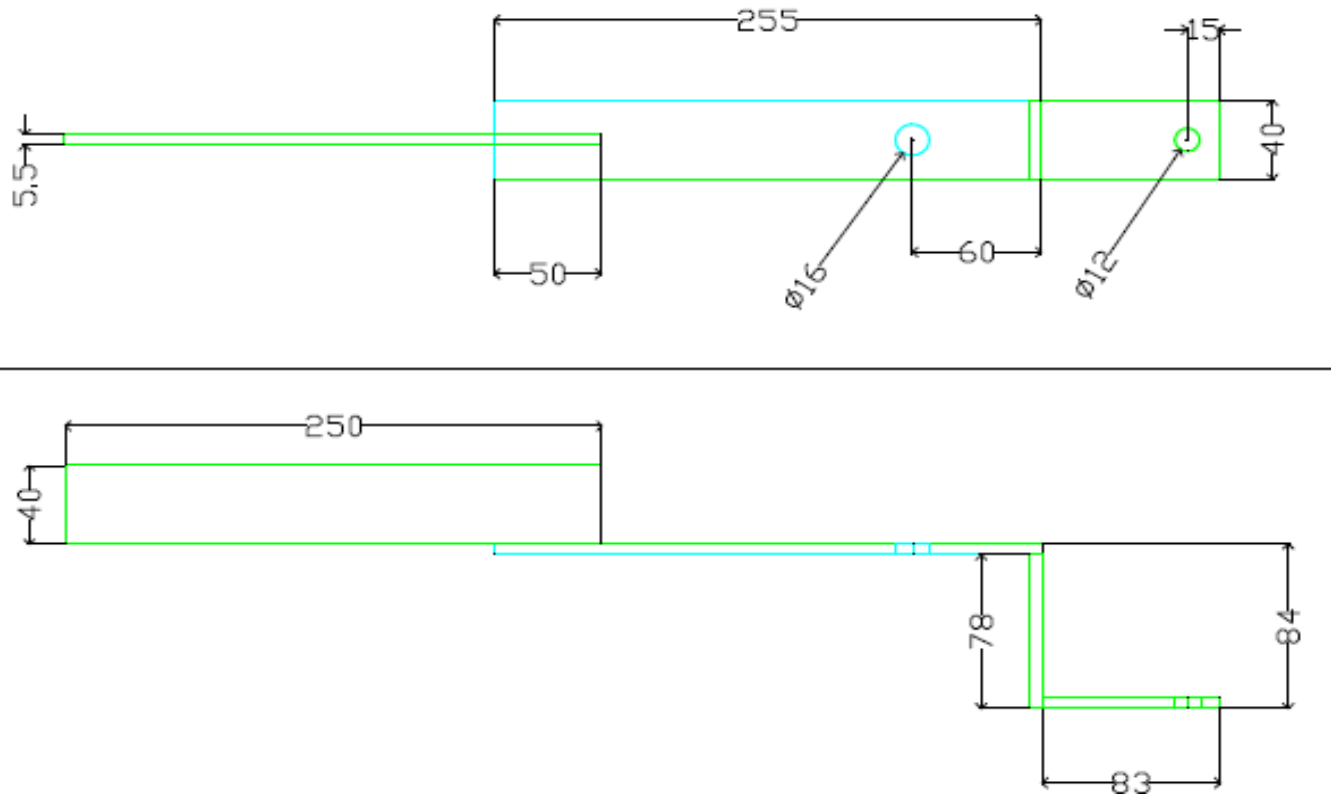

Ny fivoy tongotra « Pedale »

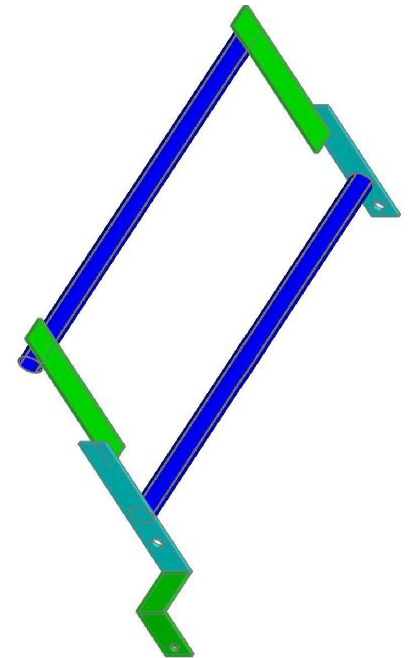
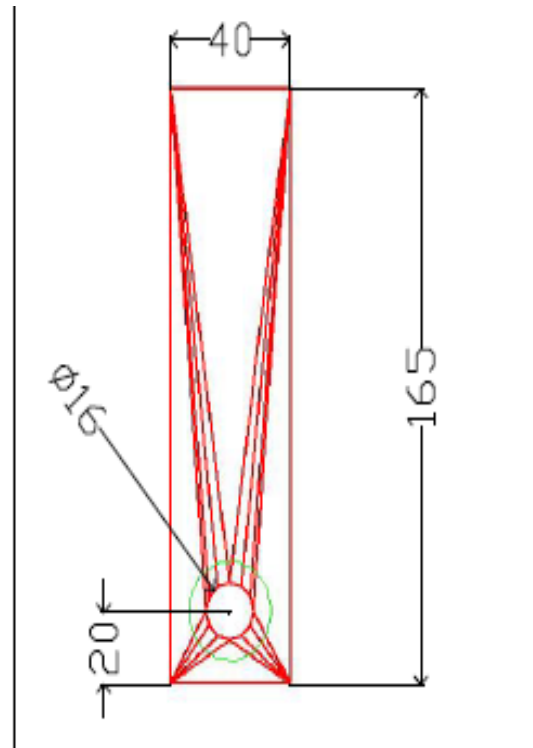
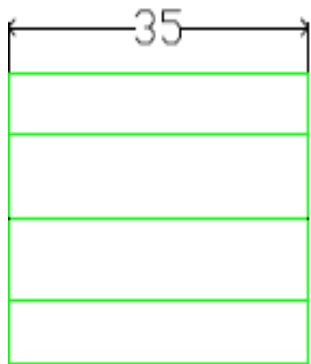

Ny saron`ny Fikapoham-bary voizin-tongotra

Ny saron`ny batteuse dia natao hiarovana ny voam-bary tsy hiparitaka mandritry ny fotoana ikapohana ny vary.

Toy izao ary ny refin`ny Labasy « Bache » ilaina amin`izany:

